

## Thank you for choosing Quickfit Blinds and Curtains!

We appreciate your purchase of the S-Fold Curtain Track System. Before starting, please check that all hardware and components are included in the package.

### Pro Tips for Installation

- Install the S-Fold tracks before measuring curtain lengths to ensure precise curtain drop measurements.

With the right setup, your curtains will hang beautifully, creating a polished and stylish look. Let's get started!

### Important Notes:

Before installation, ensure you have the correct fixings. The screws provided are for timber. For mounting on other materials, use the appropriate fixing method based on the wall material. Visit your local hardware store for suitable options.

Images in this installation guide are generic and for reference only. Fixtures may vary.

### What's in the Box?

Your package contains the following items:

Hardware	140cm Track	180cm Track	220cm Track	280cm Track	360cm Track
Number of Track Sections	2 x 70 cm	2 x 90 cm	2 x 90 cm 1 x 40 cm	3 x 93 cm	4 x 90 cm
Screws	8	8	12	12	16
Masonry Plugs	8	8	12	12	16
Ceiling Brackets	4	4	6	6	8
Wall Brackets	4	4	6	6	8
End Caps	2	2	2	2	2
Plastic Runners on Cord	20	26	30	40	52
Joiner	2	2	3	3	4
Wand Clip (Wand not included)	2	2	2	2	2

### Tools You'll Need (Not Included)



- Screw Driver - Phillips head
- Stud finder
- Pencil
- Iron
- Scissors
- Ladder
- Tape measure
- Spirit level
- Drill

**Note:** Double wall mount brackets are available for these tracks if required and can be ordered separately from our website.

### Care Instructions:

Periodically remove your curtains and vacuum inside the track to keep the runners gliding smoothly and ensure long-lasting performance.

**THIS INSTALLATION PROCESS SHOULD BE COMPLETED BY SOMEONE WITH DIY EXPERIENCE.**

# Track Installation Guide

## Step 1: Choose Your Mount Type

The S-Fold Track System supports both wall-mounted and ceiling-mounted options.

Select based on your preferences and ceiling height.

### Pro Tip:

- The curtain drop is 250cm from the top of the curtain (fabric). This will mean if you would like the curtain to sit just above the floor then the top of your track should be mounted 252cm from the floor. S-Fold curtains are underslung meaning they sit under the track.
- If you are ceiling mounting your curtains on the ceiling and your ceiling height is not 252cm and it is a bit lower your curtains will touch the floor. Curtains slightly touching the floor is a current trend right now and actually look very nice and a little tailored.
- If your ceiling is higher than 252cm then you will need to wall mount your tracks or the curtains will be too short

### Dimensions

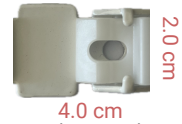

## Step 2: Assemble your Curtain Track

- Lay your track pieces on a working desk or floor. Use the allen key to loosen the screws on the joiners, then slide the joiner onto the end of both tracks, and tighten the screws with the allen key to connect the tracks to your desired length.
- Thread the corded runner into the track or 2x corded runner for centre opening
- Attach the end cap to the ends of the track. Slide it inwards and then screw it tight. Depending on your preference for curtain movement: If you want the entire curtain to be able to move, make sure the final runner is positioned outside the end cap space. If you'd like to prevent the curtain from moving all the way across, ensure it is placed within the end cap.

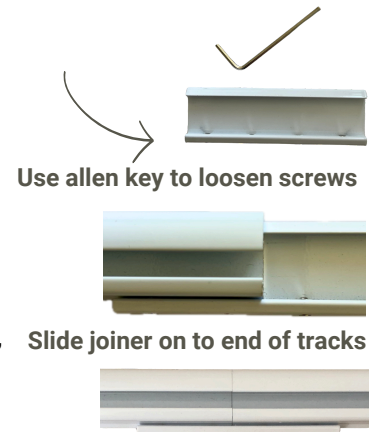

### Note:

- You can cut the track down to your desired length with a hacksaw but you need to keep the number of runners provided on your string in the track (do not cut any runners off your cord)
- Additional joiners are included to allow multiple sets to be connected to each other.
- If you have a 280cm track and have ordered centre opening you will need to cut the corded runner in the middle (20 runners on each half)
- If you have ordered a 360 track and ordered centre opening you will need to cut the corded runner in the middle (26 runners on each half). If you are doing side opening you will need to cut the corded runner so 48 runners remain on the cord. (The cord supplied will have 52 runners)

## Step 3: Positioning Brackets

Mount brackets securely to ceiling or wall with suitable screws/fixings and clip your track to the brackets.

### Note:

S-fold curtains are designed to fall in a wave pattern under the track, taking up approximately 12–13 cm of depth. To allow enough space, ensure the **centre of the track** is positioned at least **6.5 cm away from the wall**. Install your brackets accordingly.

### Pro Tip:

- Use a stud finder to find timber behind the plaster or use plaster plugs from your hardware store
- First and last supporting bracket should be 5 - 15 cm from end of track
  - Space supporting brackets as evenly as possible (at least one supporting bracket per track piece) - recommended approximately 40 - 50 cm spacing between supporting brackets.
- Check levels before drilling to ensure the track is perfectly straight.
- Position Your Track
  - Centre of Window: Ideal if the window is central to the wall.
  - Centred to Wall: Useful for off-centre windows or to extend curtains beyond the window frame

## Step 4: Install the Track

Loosen the plastic track holder screws on each bracket.

1. Tilt the track so the ridge fits under the plastic track holder.
2. Straighten the track and push the other edge under the curved metal edge of the bracket, you'll hear a click in
3. Push the plastic track holder forward and tighten the screw

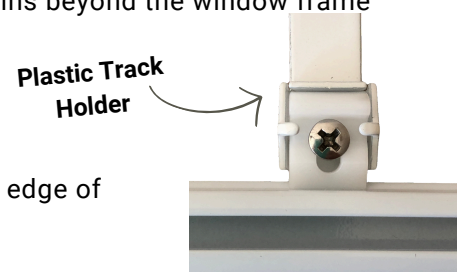

## Installing & Hanging Your S-Fold Curtains

Once your Quickfit S-Fold Track has been securely installed, you're ready to hang your curtains and complete the look. Before you begin, ensure:

- All screws are tightened
- Brackets are firmly secured
- The track is level and gliders move freely along the channel

## Hanging Your Curtains

To achieve the perfect S-fold finish, your curtain has been made with a button header designed to work seamlessly with the runner cord supplied.

The runner cord included in your package should match the number of buttons on your curtain header. Occasionally, there may be one or two extra runners – this is normal. Once installation is complete, simply trim off any excess runners from the cord.\*

Track Width	No of Runners	Panel size	No. of Buttons on header
140 cm	20	245 x 250	20
180 cm	26	320 x 250	26
220 cm	30	370 x 250	30
280 cm	40	470 x 250	38
360 cm	52	595 x 250	48

\* **360 Track Orders** - If you have ordered a 360 track, please note:

- Centre Opening: Cut the corded runner in the middle so there are 26 runners on each half.
- Side Opening: Cut the corded runner so that 48 runners remain on the cord. (The supplied cord will contain 52 runners.)

## We Recommend Two People for Installation

For best results, we recommend two people for hanging your curtains – one person to support the weight of the curtain, and the other to secure the buttons into the runners.

### Pro Tip:

If hanging your curtains alone, gather the fabric over your shoulder with the buttons facing the rail. This will help support the weight while you insert the buttons into the runners.

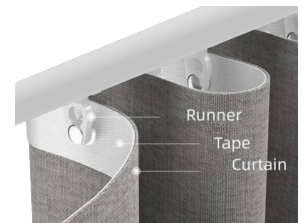

**Step 1** - Position the curtain with the tape/header side facing the window (refer to Fig. 1 if applicable).

Fig. 1



**Step 2** - Starting at one end of the track, insert the first button into the first glider on the corded runner that has already been threaded into the S-Fold track.

**Step 3** - Continue inserting each button into the corresponding runner, working steadily across the track until all buttons are secured

**Adjust the curtain folds** Fold the fabric so the first fold is forward between the first 2 gliders, then the next fold back and so forths that the curtain snakes underneath the track and create beautiful s-fold waves. (refer to Fig.2)

Fig. 2

